

## MALL PLUS - SIZEABLE SHOP SPACE FOR LEASE

- The Premises** : Shop G01, Levels 1 & 2, Mall Plus, 388 Hennessy Road, Hong Kong
- Gross Area** :           G01           519 s.f.  
                          L1           7,370 s.f.  
                          L2           8,934 s.f.  
  16,823 s.f.
- Rent** : HK\$990,000 per month (negotiable)
- A/C & Management Fee** : \$10.0 p.s.f. per month       (Central A/C supply hours: 10am - 10pm daily)
- Availability** : Immediate
- Remarks** :  
· Rare opportunity of sizeable space with excellent exposure for retailers  
· Prominent corner location in one of the most popular shopping hubs in Hong Kong  
· Over 140 feet wide external façade and promotional light boxes facing 2 main streets  
· Huge signage positions at the corner between Hennessy Road and Tin Lok Lane  
· Spacious G/F main entrance at the building corner  
· Exclusive escalators linking up G/F to Level 2 and one passenger lift serving all floors  
· Suitable for variety of trades such as fashion, accessories, jewellery and watch, audio visual appliances, health & fitness, co-working space and bank, etc.



Subject to Contract & Availability

The material herein is intended as a guide only, no liability for negligence or otherwise is assumed for the material contained herein by Man Hing Hong Group, its principal or its servants or its agents. No material contained herein shall form the basis of or be part of any agreement and no warranty is given or implied as to the accuracy of the whole or any part of the material. Prospective tenants should not rely on the material but should make their own enquiries and satisfy themselves of all aspects of the material.

**MAN HING HONG PROPERTIES**



The Premises    Signage Position    Light Boxes

**G/F Main Entrance with Huge Signage Positions**



**Artist Impression of Level 2**



**Location Map**



**Floor Plan**

*(For Identification Purpose Only - Not to Scale)*

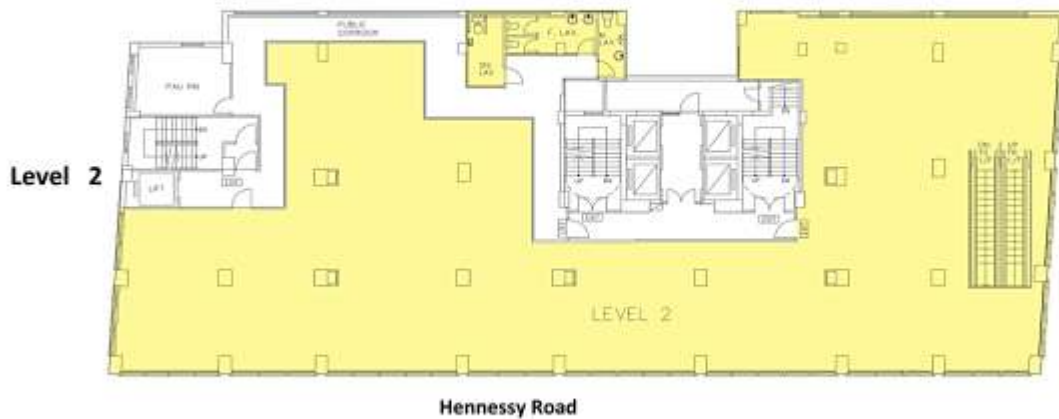
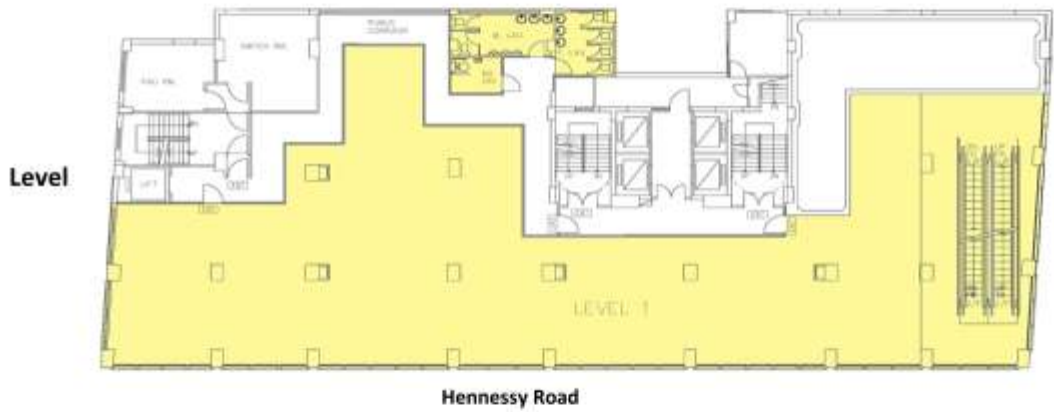
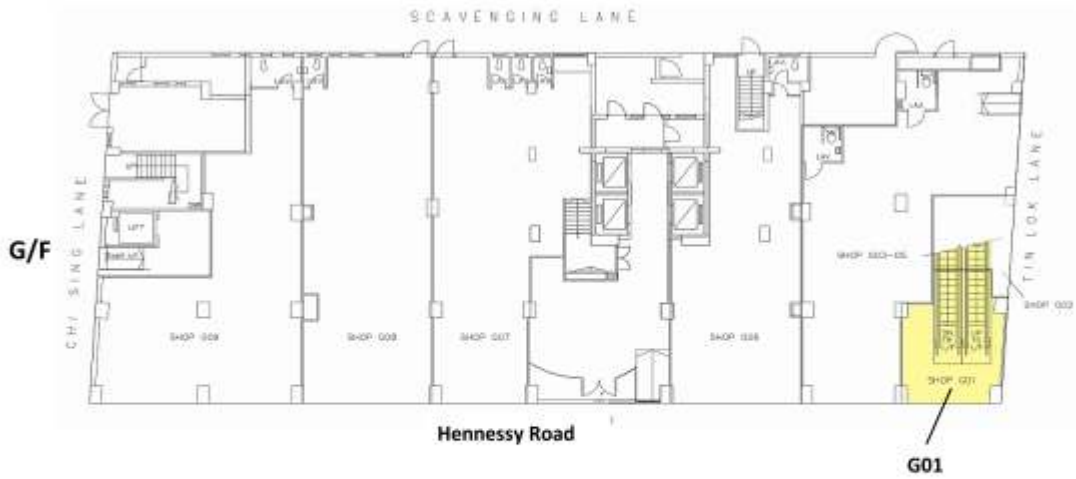

 The Premises

